

GROUND FLOOR
 APPROX. FLOOR
 AREA 415 SQ.FT.
 (38.5 SQ.M.)

1ST FLOOR
 APPROX. FLOOR
 AREA 349 SQ.FT.
 (32.4 SQ.M.)

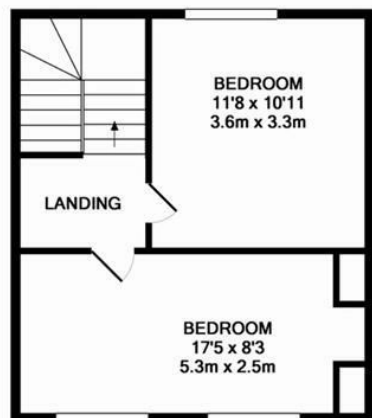

2ND FLOOR
 APPROX. FLOOR
 AREA 348 SQ.FT.
 (32.3 SQ.M.)

TOTAL APPROX. FLOOR AREA 1111 SQ.FT. (103.2 SQ.M.)

Whilst every attempt has been made to ensure the accuracy of the floor plan contained here, measurements of doors, windows, rooms and any other items are approximate and no responsibility is taken for any error, omission, or mis-statement. This plan is for illustrative purposes only and should be used as such by any prospective purchaser. The services, systems and appliances shown have not been tested and no guarantee as to their operability or efficiency can be given.
 Made with Metropix ©2016



Mildmay Park, London
£4,600 Per Month
 4 bed, House - Detached

Photos
 coming
 soon...

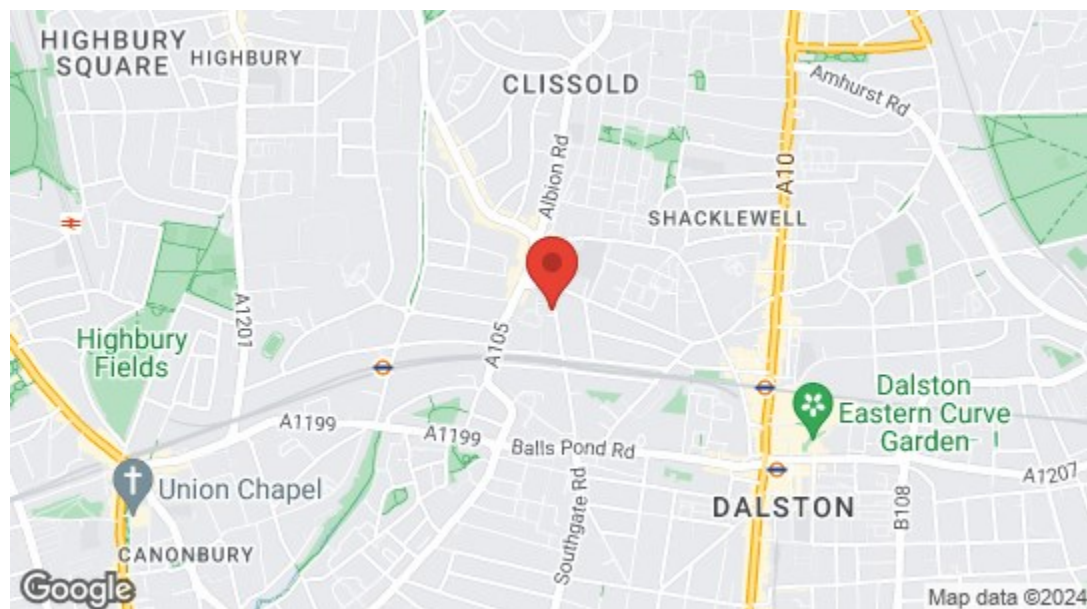

Energy Efficiency Rating		Current	Potential
Very energy efficient - lower running costs			
(92 plus)	A		
(81-91)	B		
(69-80)	C		
(55-68)	D		
(39-54)	E		
(21-38)	F		
(1-20)	G		
Not energy efficient - higher running costs			
England & Wales		66	
		EU Directive 2002/91/EC	



Features

- Bright And Spacious Four Bed
- Split Over Three Floors
- Private Patio Garden
- Excellently Located Near Newington Green
- Close To Dalston Kingsland Station
- EPC Rating D
- Council Tax Band E

A spacious and perfectly placed four bedroom period conversion, arranged over three storeys, with one bathroom, twin receptions and a private patio. All just moments from Newington Green.

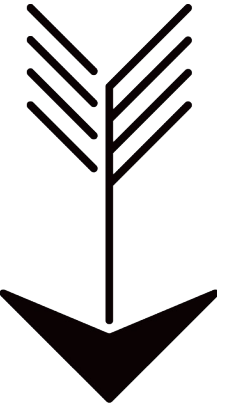

WHAT ELSE?

Newington Green boasts a variety of popular eateries, bars and grocery shops, including All Greens Green Grocers, Jolene, Cadet and Perilla. Additional shops, cafés, and restaurants are available on Stoke Newington Church Street, Upper Street, and in Dalston. For open spaces, residents can enjoy Newington Green, Clissold Park to the north, and Highbury Fields to the west.



IF YOU LIVED HERE...

Situated in the sought-after Mildmay area, this property spans over 1000 square foot, offering bright and spacious accommodation. Mildmay is a vibrant neighbourhood known for its leafy streets, beautiful Victorian architecture, and a strong sense of community. The property is a short walk from both Canonbury and Dalston Kingsland stations, offering convenient commutes to the City and Central London.